

# Bischoff

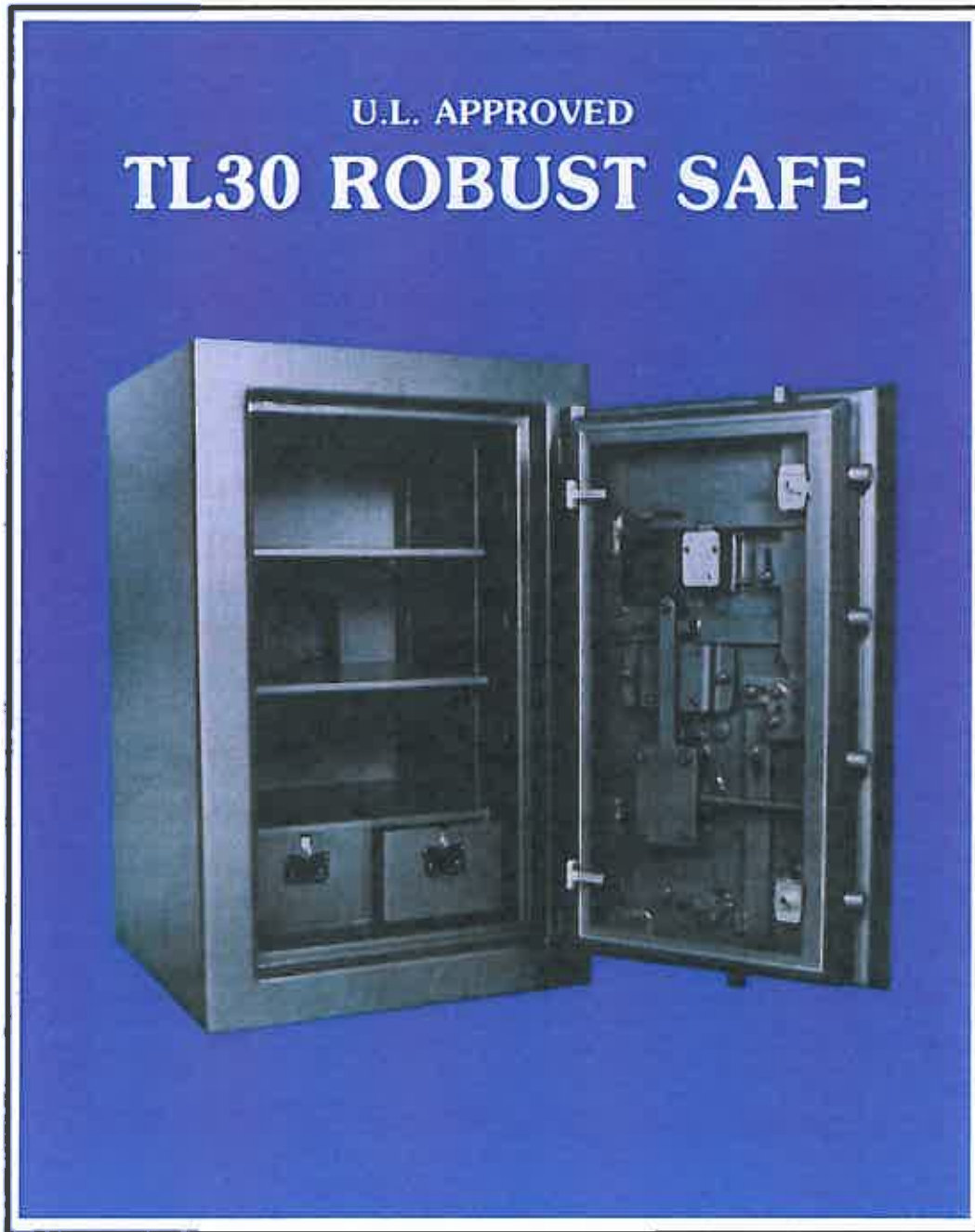

The Bischoff Safe & Electro Security Group



Imported for Jewelers by JEWELERS SAFE CO.

# THE ROBUST TL 30 WITH S

## TL30 ROBUST SAFE

This high quality safe offers six sided protection against most known methods of attack. It will afford an extremely high degree of protection against heavy hand tools, high speed drills, wedging, disc cutting and explosives. To a lesser degree it will afford protection against oxy-acetylene cutting torches.

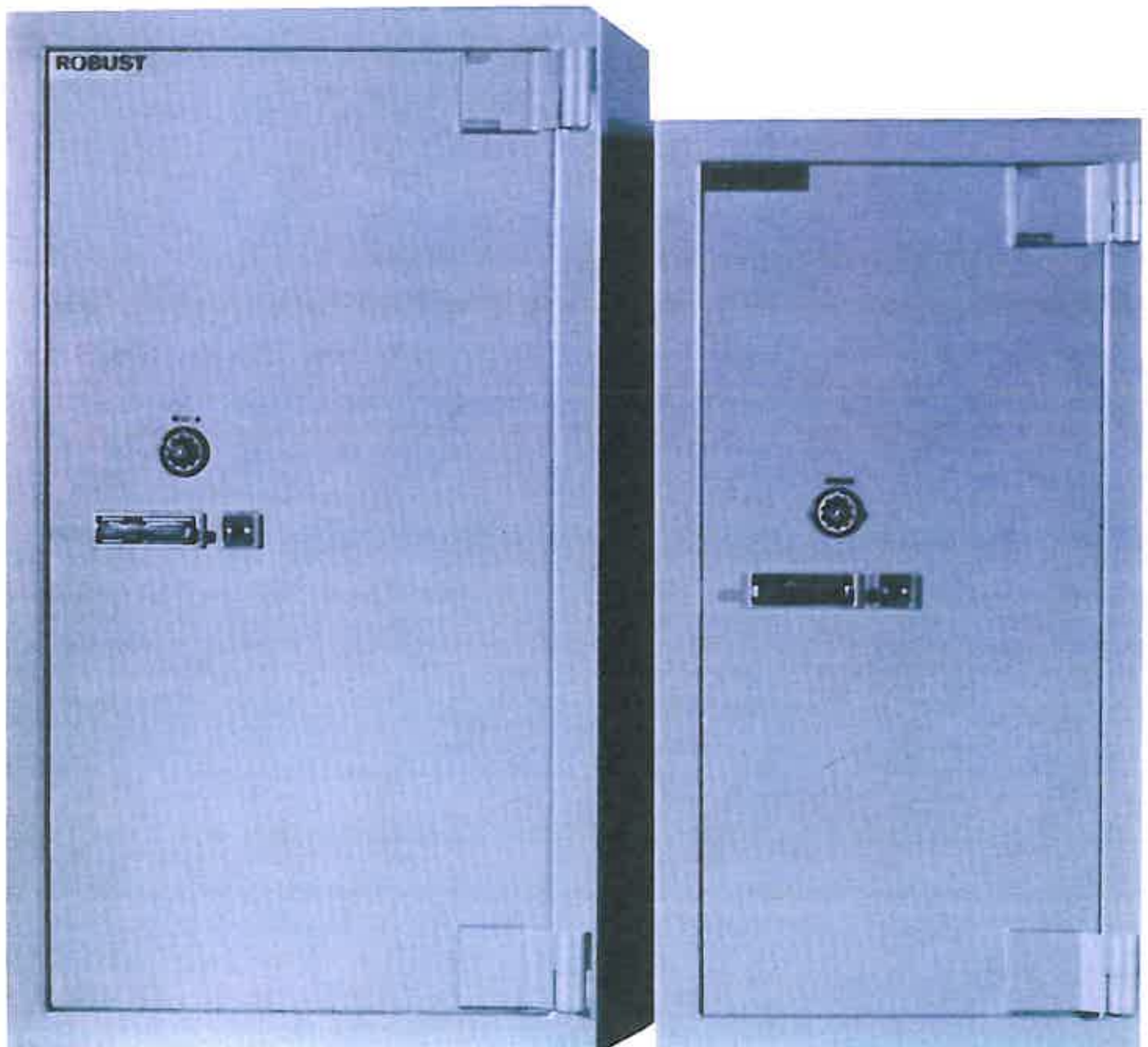

**BS9**

**BS8**

# X SIDES OF PROTECTION

## DOOR

The overall thickness of the door is 6-1/8". The total protective thickness is 2-5/8" constructed with 1/4" steel on the outer surface with 2 inches of anti-drill material which incorporated stainless steel lugs. The entire door is additionally protected by hardened steel plate.

The standard locking is one Underwriter's Laboratories Group 2 Combination Lock and one eight lever keylock.

There are both live and captive relocking devices, which are in themselves protected by a hardened tempered glass plate. This glass plate will shatter if attacked by any method, activating the relocking devices—therefore locking the safe from the inside.

The door has three way boltwork and a fixed dog bolt on the back edge of the door. The bolts are 1-1/4" in diameter.

## BODY

The body construction is the equivalent strength to the door being 4-1/2" in overall thickness. Special reinforcement is built in to protect the bolt heads. The total strength of the anti-drill material is 14,000 pounds per square inch.

Interior fittings: adjustable shelves and two lockable half width drawers fitted at the bottom of the safe.

The safes are finished either in dark grey or gold beige.



**BS7**



**BS4**



**BS2**

# DIMENSIONS AND WEIGHTS

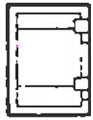

BS2

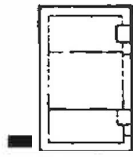

BS4

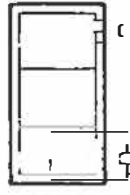

BS6

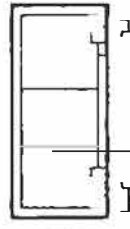

BS7



BS8

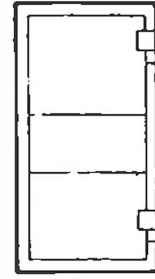

BS9

MODEL	INSIDE DIMENSIONS			OUTSIDE DIMENSIONS			CUBIC INCH CAPACITY	APPROX TOTAL WEIGHT
	HEIGHT	WIDTH	DEPTH	HEIGHT	WIDTH	DEPTH		
BS2	23"	19"	18"	32"	28"	30"	7866	1935 lbs.
BS4	35"	19"	18"	43"	28"	30"	11970	2552 lbs.
BS6	46"	19"	18"	55"	28"	30"	15732	3212 lbs.
BS7	54"	19"	18"	63"	28"	30"	18468	3740 lbs.
BS8	64"	26"	24"	73"	37"	38"	49008	5500 lbs.
BS9	70"	36"	25"	79"	45"	38"	65520	7084 lbs.



**MEGASAFE**  
**HIGH SECURITY SAFES**  
 (800) 345-6552    [www.megasafe.com](http://www.megasafe.com)